

Selector Lever Knob

Removal

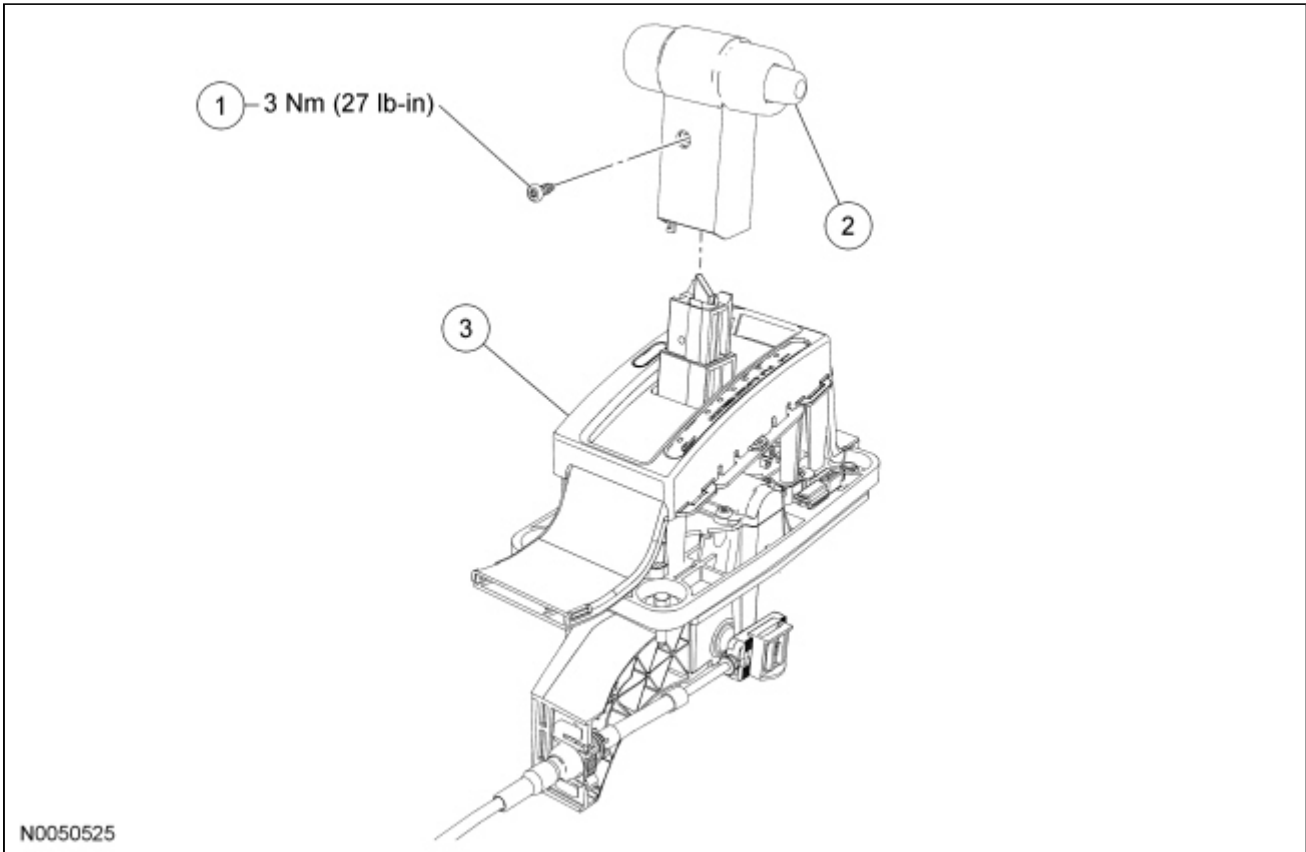

Item	Part Number	Description
1	—	Transmission selector lever knob screw
2	7213	Transmission selector lever knob
3	7210	Transmission selector lever assembly

1. Remove the transmission selector lever assembly. For additional information, refer to [Selector Lever](#) in this section.
2. With the transmission selector lever knob pulled to the rear, remove the transmission selector lever knob screw from the knob base.

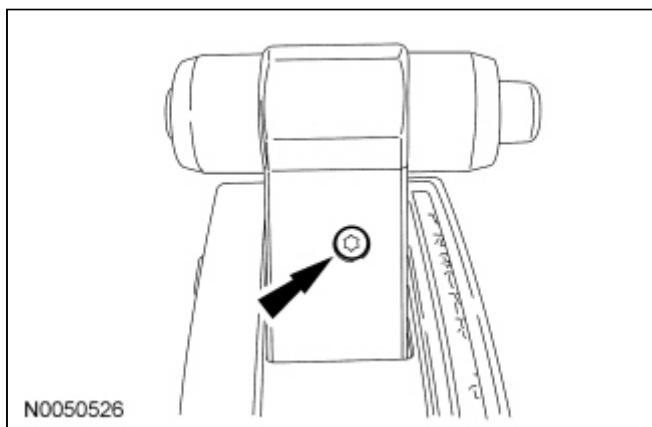

3. Slide the transmission selector lever knob up and off the selector shaft. Disconnect the Transmission Control Switch (TCS) electrical connector.

Installation

1. Connect the [TCS](#) electrical connector.
2. Fold the [TCS](#) wire into the selector shaft channel to keep the harness from contacting the sliding mechanisms.
3. **NOTICE: Tightening the transmission selector lever knob screw over 3 Nm (27 lb-in) may damage the selector lever assembly.**

Align the transmission selector lever knob base screw hole with the selector shaft and install the screw.

- Tighten to 3 Nm (27 lb-in).

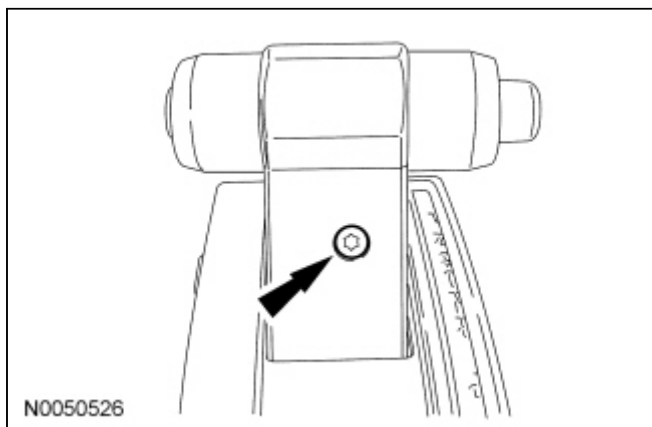

4. Install the transmission selector lever assembly in the vehicle. For additional information, refer to [Selector Lever](#) in this section.
-